



EXPERIENCE THE DIFFERENCE
YOUR SECURITY & SAFETY PRODUCTS

MK19-MGS+

MACHINE GUN SIGHT



LEARN MORE:

<http://c4communication.com>

The MGS-19 Main Components:

- MGS+ for day & NVG operation
- MK19 Mount (40mm AGL Mount)
- Option: Magnifiers, thermal sights and others



MGS+



MK19 Mount



Model: MGS-19

The MK19 Mount

Main Features

The BDC Dial:

Push the center button to rotate and select the distance



Picatinny Rail

Rubber gasket

Locking Device
(Push Type)

Ranges:

200, 300, 400, 500, 600, 700, 800, 900,
1000, 1100 1200, 1300, 1400 and 1500m

Model Number: Mk19-MT

The MK19 Mount Specs:

FEATURE

DATA

Range selection

200 to 1500 m

Spin drift compensation

Yes (2-Axis)

Picatinny rail

One Picatinny rail to install a MGS+ or thermal weapon sight

Mounting

Via the Sight Bracket Interface

Material

High strength aluminum

Weight

~2.2 Lbs (without sight)

Dimension

~8 X 5 x 2 Inches

Model #:

Mk19-MT

About the Machine Gun Sight (MGS+)

- The MGS+ is designed and developed primarily for all **crew-served weapons**.



- The MGS+ modular design allows for quick target acquisition and simplifies the shooting process—Just point & shoot.

- Easy to configure for a specific mission
- Easy to upgrade and repair
- Universal Sight –One sight for ALL crew served weapons

- The MGS+ with a very large FOV which enables:

- One-Shot-One-Hit capability
- Improved Situational awareness
- Improved accuracy -reduce collateral damage concerns



- With **extra wide field of view**, the MGS+ offers both-eyes-open shooting for both stationary and moving targets. ***The MGS+ reduces training time and save ammunition !***

- It offers shooters pinpoint accuracy and enhances operator's confidence in the battlefield.

MGS⁺ MainComponents

(Model:MGS⁺M3X)

- The MGS⁺ is a Universal CSW sight and consists of the following modules:

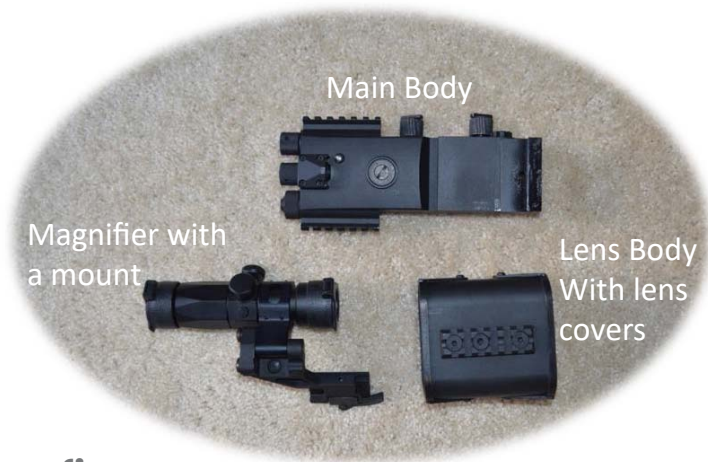

NSN: 1220-01-674-2750



- **Benefits**

- Easy to UPGRADE
- Easy to Support and Repair
- Easy to configure for a specific mission

MainFeatures

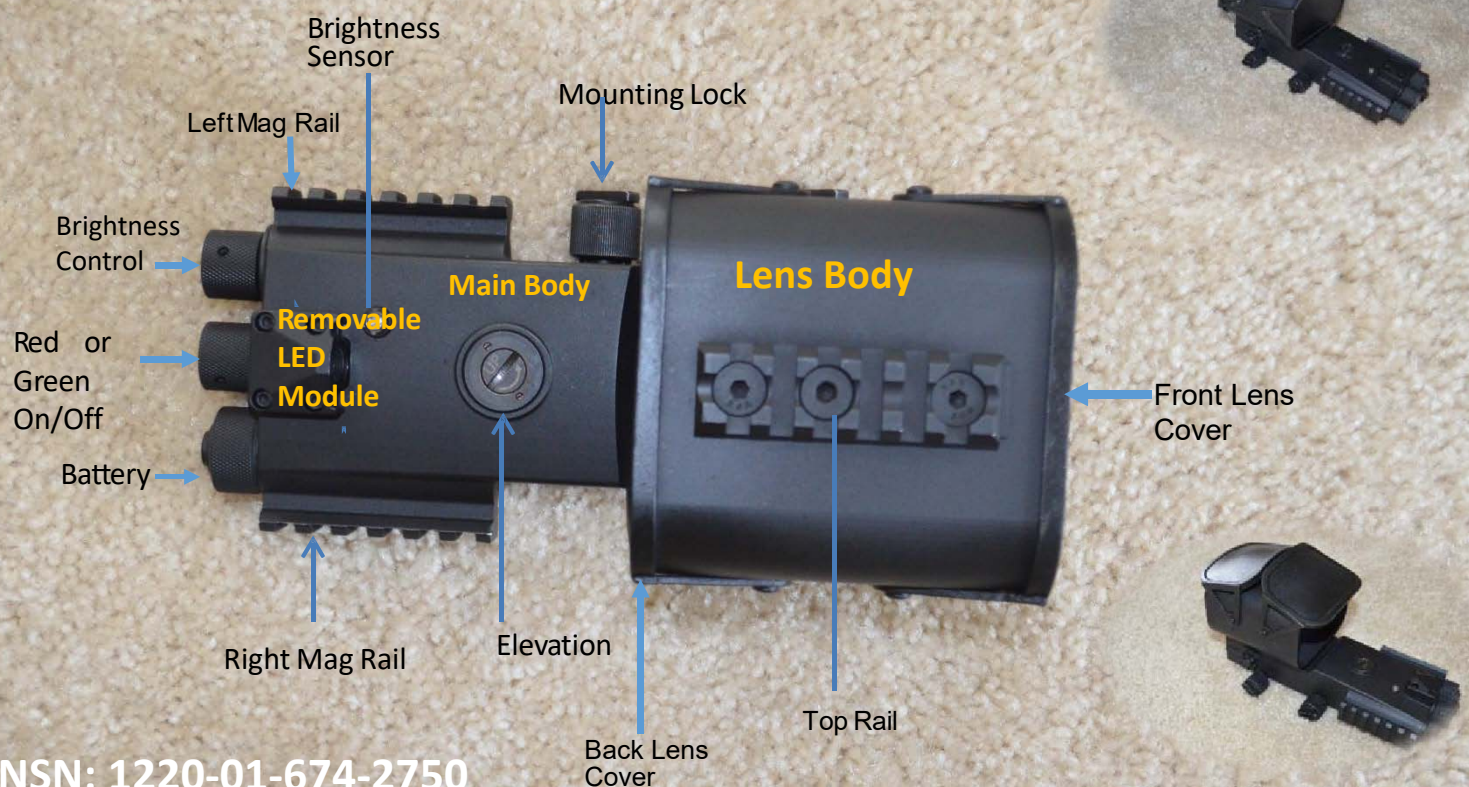

The mgs achieves faster target acquisition time and increase first burst probability of hit (p(h)) for machine gunners firing from the ground or from vehicle mounted platforms-stationary or moving.

Specifications

(NSN: 1240-33-2149291)



Model	MGS+M1X
Calibers	7.62 / 12.7/40/20
NSN	1220-01-6742750.
Dimensions[L x W x H]	~8.6x 4.3 x 4.5 in (220x110x115mm)
Weight	~2.2 Lbs (~ 1.4kg)
Lens Size	~3.5 x 2 in [80 x 50 mm Actual size]
Total Field of View	~80m at 200m [>25 degrees]
Azimuth/Elevation Adjustment	~0.5 MOA/click
Eye Relief	Unlimited
Red Dot or Green Dot Size	Dot = 3 MOA Circle = 35 MOA
LED colors	Red and Green selectable
Night vision	3 settings
Brightness Adjustments	8 settings+ (On/off)
Magnification-Option	3X, 5X, 3-5X or 3-8X Variable
Power Supply	1 type 123 3V lithium
Battery Life ~1000+ hr	~1000 hr
Mounting	MIL-STD-1913 rail
Operational Temperature	-41°C to +71 °C

The MGS+ is designed to survive in operational military environments in accordance with MIL-STD-810G.

Benefits of the MGS-19 (Mk19 Sight)

- **Large FOV sight**
 - Faster target acquisition / aiming
 - Improves the accuracy & probability of hit out to the maximum range of the weapon
 - Spin drift compensation
 - Reduces ammunition consumption
- **Provides a more natural shooting position by bringing the sight closer to the center of the barrel**
- Rugged/Dependable
- **Light Weight**
- **Easy to install/Use**
 - Using standard Sight Bracket Interface
- **Access to the backup iron sight**



Option

- **Magnifiers**
 - 3X fixed
 - 5X fixed
 - 3-5X or 3 -8X Variable Magnifier
 - Left Flip Mount
 - Right Flip Mount



- **Large Lens for the MGS+**



Option: Laser Boresighter



Case Material	Brass
Surface(protect)finish	Blue electrostatic painting
Dimensions (L x D)	44.57(41.16) mm x 99.95mm
Weight	800g
Battery	CR123A 3V Lithium battery 1 EA
Switch	Button on/off
Battery life (hours)	3 hours 30 minutes (continuous use)
Life	50,000 hours
Temperature Range	- 40°C~ 50°C
Storage temperature	-45°C ~ 85°C
Light Source	Red visible laser
Wavelength	650 nm
Laser Power Output	30 mW

Option: Thermal Weapon Sight-Night

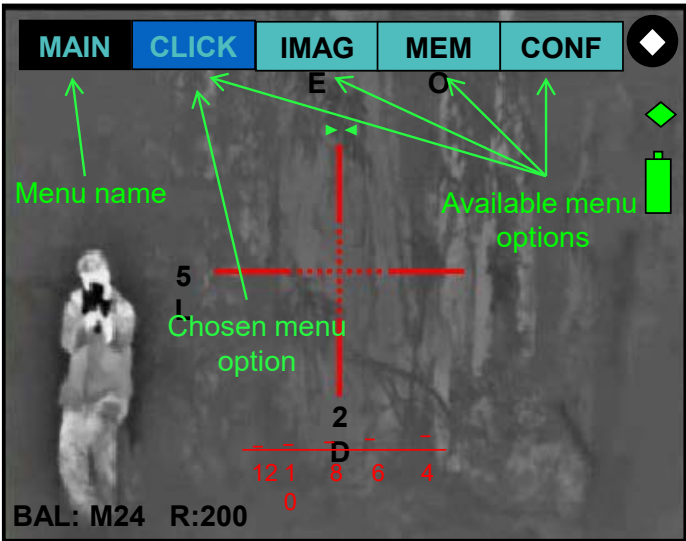

Quick Installation



Step 1: Install the Sight Bracket Interface

- It is a US military standard bracket
- Most of the MK19 used by US forces come with the Sight Bracket Interface

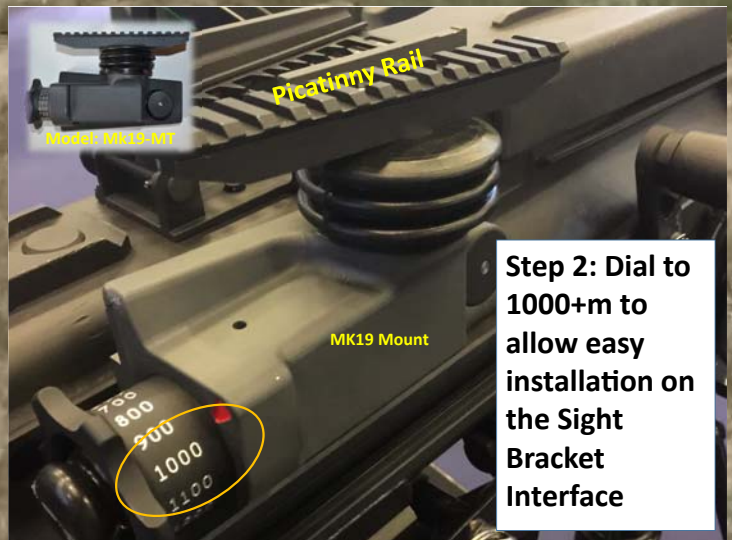

Step 2: Dial to 1000+m to allow easy installation on the Sight Bracket Interface

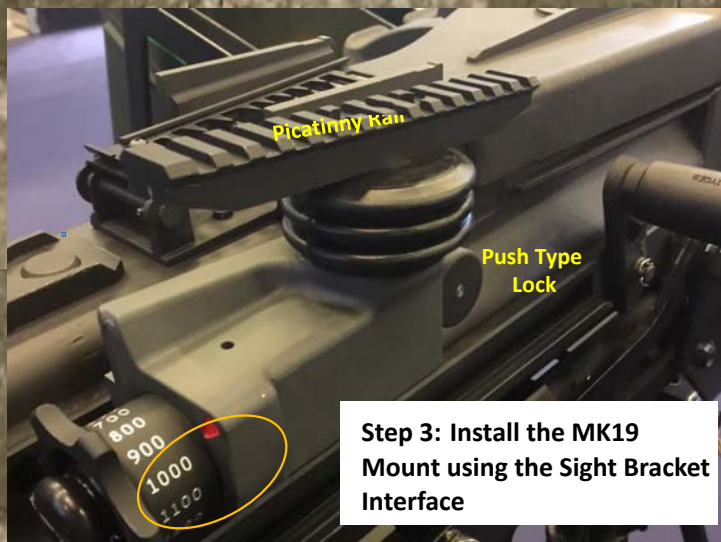

Step 3: Install the MK19 Mount using the Sight Bracket Interface



Step 4: Install the MGS+ on top of the Picatinny Rail

How to use it?

- The MGS-19 is very user friendly
- Zeroing at 500m using the Iron sight
- Select a target and estimate the distance using our Large FOV Lens/Reticle
- Dial the correct distance from 200m-1500m
- Point the Red or Green dot to the target
- Just point & shoot!!



Range Estimation

Using the circle reticle, the range of various targets can be estimated. Figures below shows some common targets and estimated ranges, based on the reticle size of 35 MOA.

target	Target fills 100%	Target fills 50%	Target fills 25%
Car (1.5 m high)	 ~150 m	 ~300 m	 ~600 m
Humvee (2 m high)	 ~200 m	 ~400 m	 ~800 m
Soldier (2 m high)	 ~200 m	 ~400 m	 ~800 m
Truck (3 m high)	 ~300 m	 ~600 m	 ~1200 m



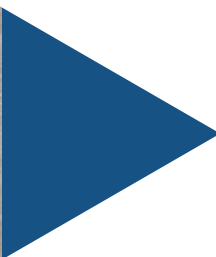

LEARN MORE: c4icommunication.com

FOR MORE INFORMATION: contact@c4icommunication.com or +1 (302) 981 1340